



apreamare.it

**apreamare**
MEDITERRANEAN YACHTING CULTURE

GOZZO **35**
EUROPEAN STANDARD EQUIPMENT

GOZZO 35

1 PROPULSION

2 X VOLVOPENTA D4-270hp DPI - stern drive

2 X VOLVOPENTA D4-320hp SH - shaft line

DATA SHEET

2 SPEED

	VP D4 270 DPI		VP D4 320 SH
Maximum speed	33	knots	31
Cruising speed	28	knots	26

3 RANGE

	VP D4 270 DPI		VP D4 320 SH
Maximum speed	228	n.m.	160
Cruising speed	243	n.m.	228

4 MAIN DIMENSIONS

Length overall (LOA)	11,20	metri/feet	36 ft. 9 in.
Hull/homologation length	9,95	metri/feet	32 ft. 8 in.
Waterline length	9,64	metri/feet	31 ft. 8 in.
Maximum beam	3,70	metri/feet	12 ft. 2 in.
Draft	0,90	metri/feet	2 ft. 11 in.
Displacement unladen	7,0	ton./lb.	15432
Displacement laden	9,0	ton./lb.	19842
Max. number of persons on board	14		
Navigation/homologation category CE	B		

5 ADDITIONAL DATA

Variable geometry hull type with support skids

Maximum height for transportation	3,95	metri/feet	12 ft. 11 in.
Fuel tank capacity	700	lt./US gals.	185
Fresh water tank capacity	170	lt./US gals.	45
Black water tank capacity	50	lt./US gals.	13

N.B. All data's are merely indicative, refer to a standard model, and therefore have no contractual value. Apremare, in the light of a continuous improvement, reserves the right to change and/or update them at any time and without prior notice.

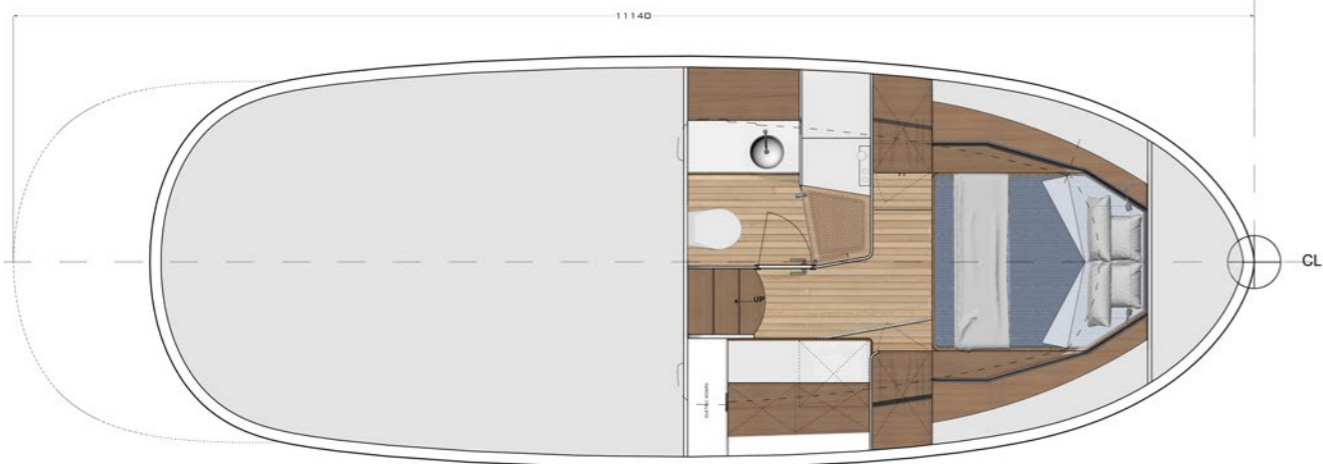
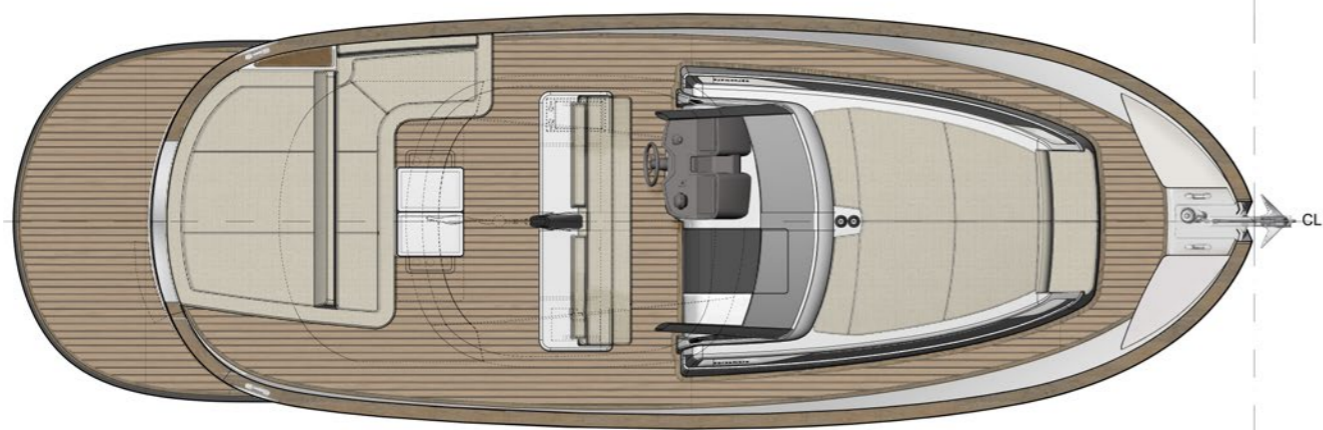

EXTERIOR

HULL AND DECK

1000 W electric winch with control in the pilot station and at bow

Access door at stern in fiberglass, manual opening

Access to the engine room with fiberglass hatch moved by gas pistons

Aft sunbed with electric opening for access to engine room and storage

Aft sunbed, pilot seats, bow sunbed and sofa with cushions

AISI 316 mooring cleats (2) at aft and (2) at bow

AISI 316 steel mast with navigation lights

Anchor chain: 8 mm thick, 50 mt long

Antifouling

Berthing hook housed under gunwale

Cockpit bar fittings with fiberglass sink, water tap and nr. 2 corian top; 65 lts fridge and cabinet with shelves holders

Fiberglass hull painted in white gelcoat

Fire-extinguisher

Flagstaff

Fresh water fill on the port side on the aft sofa

Fuel fill installed on the port side of the aft sunbed

Horn for acoustic alarm

Manual foldway swim ladder in the stern platform

Manual plexiglass door for access in lower deck

Painted stripe and waterline (colour chosen by the customer)

Plexiglass front and side windscreen

Pvc "Crystal" windproof between front windscreen and T-Top

Stainless steel deck equipment

Stainless steel handrail at stern

Stainless steel handrails on the sides of the aft sunbed

Stern shower with cold water

Teak wood cockpit, sidewalks and stern platform

Teak wood gunwale

Trefoil anchor – weight 10 kg

Waste deck filler installed on the port side on the aft sun bed

White laquered wooden table with adjustable support

PILOT STATION

12 V socket

Aluminium steering wheel covered in black leather

Black painted fiberglass dashboard

Cockpit furniture with pilot seats and cushions

Display with engine-monitoring function

Engine – control levers

Hydraulic steering

Magnetic compass

Rudder angle indicator, trim tabs controls, winch control, bilge pumps switch, horn button, navigation lights switch, anchorage light switch, dashboard lights, cockpit lights switch, exhaust fans switch in engine room

INTERIOR

OPEN SPACE

12 V socket

220 V sockets

Access to the cabin with wooden ladder

Nr. 1 plexiglass opening porthole

Three-doors hanging cabinet

Two-doors storage cabinet with shelves

CABIN

220 V sockets

Curtains

Double bed with mattress, pillows, bed cover and nr. 2 drawers

Lighting system with strip led on the ceiling

Nr. 2 plexiglass fixed windows

Nr. 2 wardrobes

Upholstered ceiling

Wooden bulkheads

Wooden floor

Wooden furnitures

BATHROOM

220 V socket

Bathroom accessories: liquid soap dispenser, spare toilet roll holder, wall-mounted toilet brush holder,

towel holder, clothes hander (2)

Bathroom cabinet with glass washbasin

Electric toilet

Lighting system with strip led on the ceiling

Mirror hanging cabinet

Nr. 1 plexiglass opening porthole

Separated shower with glass doors and stainless-steel profile

Shower with seat and teak grating

Upholstered ceiling

ENGINE ROOM

12 V water pump

Automatic bilge pump

Electric bilge pump (manual)

Exhaust fans for engine room cooling

Fresh water tank (170 lts)

Fuel filters for engines

Fuel system remote controls for emergency stop

Nr. 2 engine batteries (180 Ah)

Nr. 2 engine exhaust

Nr. 2 engines installed on antivibration-damping mounts

Nr. 2 service batteries (225 Ah)

Nr. 2 steel fuel tanks (350 lts each)

Nr. 4 lights in engine room

Soundproofing and heating insulation

Waste water tank (55 lts)

SYSTEMS

220 V A.C. and 12 V D.C. electric system with electric panel and magnetothermic switch (lower deck)

Bilge water system: nr. 2 electric pumps in the engine room (automatic and manual), nr. 1 electric pump in interior compartments

Cathode-operated protection system with zinc anodes

Electric toilet operating on fresh water

Fire-fighting system

Flap system with hydraulic pump

Fresh water system





apreamare
MEDITERRANEAN YACHTING CULTURE

Apreamare Yachts
Via Terragneta, 72 - 80058 Torre Annunziata (NA)
Tel: +39 081 537 8411
www.apreamare.it